

- DK** Reservedele
- GB** Spare Parts
- DE** Ersatzteile

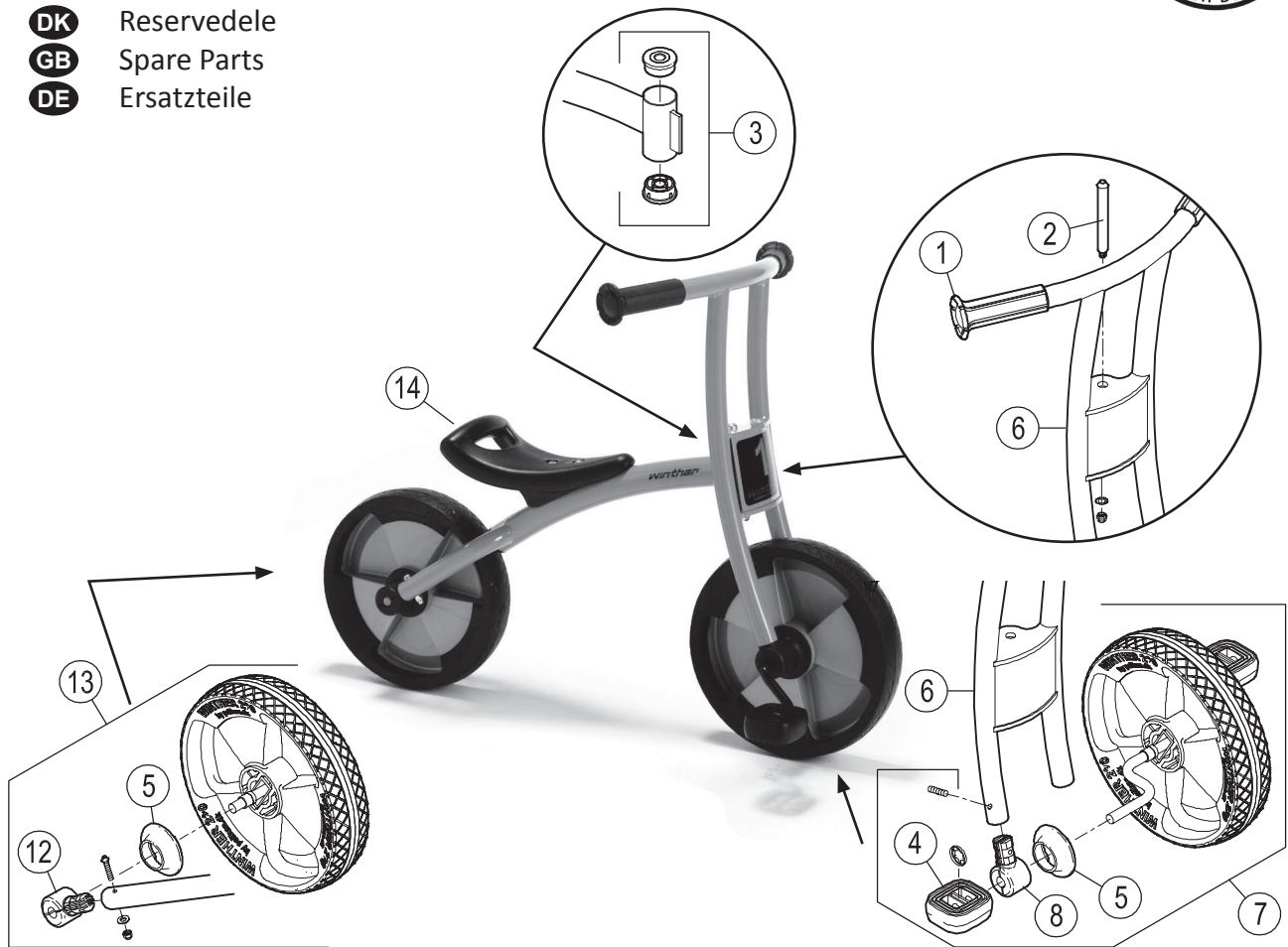

Pos.		Pos.	
1	x2 x2	8	x2 x2 x1
2	x1 x2 x1 x1 x1	9	
3	x2	10	
4	x2 x2	11	
5	x2	12	x2 x2 x2 x2 x1
6		13	
7		14	

558



EN 71

ASTM F963



- DK** Reservedele
- GB** Spare Parts
- DE** Ersatzteile



		558.00			
		Version			
Pos.	1.0	1.1			
1	WSP50417	WSP50417			
2	WSP50401	WSP50401			
3	WSP50404	WSP50404			
4	WSP50410	WSP50410			
5	WSP50405	WSP50405			
6	WSP50451	WSP50451			
7	WSP50461	WSP50461			
8	WSP50406	WSP50406			
9	-	-			
10	-	-			
11	-	-			
12	WSP50407	WSP50407			
13	WSP50474	WSP50474			
14	WSP50480	WSP50480			
15	-	-			
16	-	-			
17	-	-			
18	-	-			

